



■ Description

The EVCA-AP-SH Horn/Strobe Series provides a wide range of candela light output options in a single device. The candela settings include a 12 or 24 volt DC operation for the 15, 35 and 60 (75 on axis) candela settings and 24 volt DC operation for the 15, 35, 60, 75, 95 and 110 candela settings. The candela setting is displayed through the front window and is selectable using a drum wheel.

The horn settings include Temporal, Non-Temporal, March Time and a Chime sound. The horn also has Low, Mid and High volume settings for each pattern and tone. The tones include 2400 Hz, Electro-Mechanical, Broadband and Chime.

The voltage input can be either regulated DC or full wave rectified (FWR) 12 volt or 24 volt operation with an operating range from 8 to 33 V DC. The strobes can be synchronized using a control panel with an EVCA-AP-SMD10 sync module.

The EVCA-AP-SH utilizes a universal mounting plate that will mount on a single gang, double gang, octagon and 4" square electrical boxes. The back plate allows the installer to mount the plate and connect the wire connections. The strobe attaches in a hinge fashion from the top and is secured by a single mounting screw. The strobe completely covers the mounting back plate, therefore it can be mounted before other trades work is completed and not affect the final look.

■ Features

- UL listed
- 12 VDC with 15, 35 or 60 cd settings
- 24 VDC with 15, 35, 60, 75, 95 or 110 cd settings
- 6 distinct candela settings
- Candela selection view window
- 33 sound output settings
- Horn or chime sound output
- Pre-wire back plate
- Universal back plate mounting (single gang, double gang, octagon, or 4" square)
- Single screw mounting
- For indoor applications

■ Engineering Specifications

The installer shall provide and install the EVCA-AP-SH selectable horn/strobe. The strobe shall have six (6) candela settings. The candela settings shall be selectable using a drum roller and shall display the candela setting on the front of the device. The horn shall have 33 selectable settings configurable by dip switches. The sounder shall be capable of ANSI Temporal Code 3, March Time and produce a chime output. The horn shall have three distinct volume levels. The horn/strobe shall operate at 12 or 24 VDC regulated or full wave rectified. The horn/strobe shall have an operating range between 8 and 33 VDC. The strobes can be synchronized using a control panel with the EVCA-AP-SMD10 sync module. The strobe shall utilize a mounting plate that allows the installer to pre-wire the mounting plate. The mounting plate shall be universal and mount on a single gang, double gang, octagon or 4 inch square box. The mounting plate shall be completely covered by the strobe and shall be secured by a single screw. The strobe shall be UL listed to standard 1638, General Signaling, and standard 1971, Signaling Devices for the Hearing Impaired. The horn shall be UL listed to standard 464, Audible Signaling Devices.



Installation

CAUTION

A jumper plug is provided to test for correct wiring in the supervisory mode only. Do not pass alarm current through the jumper.

Note: Installation must comply in accordance with applicable standards.

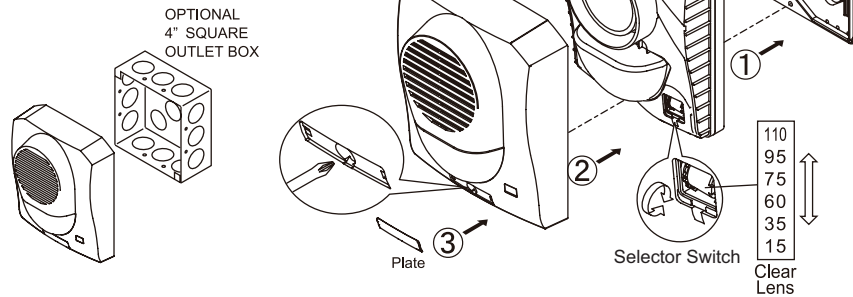

Dimensions

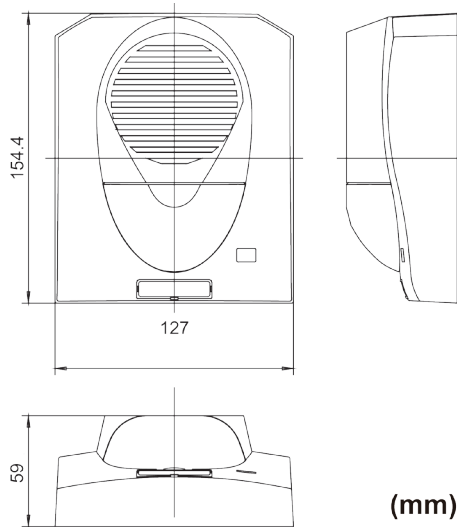

(mm)

Light Output

Light output in percentage when measured from the following directions per UL 1971.

Wall and ceiling mount horizontal dispersion

Ceiling mount vertical dispersion

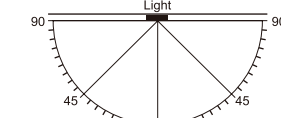

Wall mount vertical dispersion

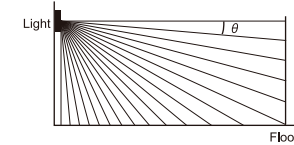

Degrees	% of Rating	
	Horizontal	Vertical
0	100	100
5~25	90	90
30	75	90
35	75	65
40	75	46
45	75	34
50	55	27
55	45	22
60	40	18
65	35	16
70	35	15
75	30	13
80	30	12
85~90	25	12

WARNING

High voltage may be present inside the light assembly even though power is not connected. If access to the component board is required (removal or replacement), the capacitor must be discharged by touching a wire to both ends of the flash tube.

DO NOT attempt to touch or move the assembly until the capacitor has been discharged.

Specifications

Strobe Current

Light Output	Max. RMS Operating Current (mA RMS)			
	Reg. 12 VDC	Reg. 12 FWR	Reg. 24 VDC	Reg. 24 FWR
15cd	116	152	62	99
35cd	209	267	102	152
60cd	254	258	131	190
75cd	NA	NA	146	208
95cd	NA	NA	177	243
110cd	NA	NA	196	268

Voltage	12/24V	
UL Designation	Regulated 12 DC/FWR	Regulated 24 DC/FWR
Operating Voltage Range	8 - 17.5 V	16 - 33 V
Flash Rate	1 Hz (60 times/ min.)	
Sync Module (EVCA-AP-SMD10)	N/A	Available
Operating Temperature Range	Indoor model: 0°C to 49°C (32°F to 120°F)	

Dipswitch Settings

Horn Dipswitch

Pattern

1 ON - Non-temporal

1 OFF - Temporal

Both 2 = OFF

1 and 2 ON = March Time

Tone

3 and 4 ON = 2400Hz

3 ON and 4 OFF = Electromechanical

3 and 4 OFF = Chime

3 OFF and 4 ON = Broadband

Volume

5 and 6 ON = High

5 ON and 6 OFF = Mid

5 and 6 OFF = Low

7 and 8 ON = Horn/strobe on 2 wires

7 and 8 OFF = Horn and strobe on 4 wires

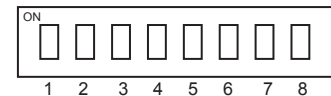

■ Specifications

Non-Temporal Horn Current

Pattern	Volume	Max. RMS Operating Current (mA RMS Current)				dBA Reverberant Ratings per UL464 (dBA @ 10 ft.)	
		Reg 12 VDC	Reg 12 FWR	Reg 24 VDC	Reg 24 FWR	Reg 12 VDC/ FWR	Reg 24 VDC/ FWR
2400 Hz	High	119	79	87	125	87	87
	Mid	44	46	28	74	82	82
	Low	30	30	18	41	79	80
Electro-Mechanical	High	118	77	81	121	86	87
	Mid	43	43	26	67	82	84
	Low	27	29	16	36	79	80
Broadband	High	146	125	78	148	86	86
	Mid	41	63	26	64	81	82
	Low	28	40	16	39	77	79
Chime	High	27	35	21	27	70	70
	Mid	11	15	8	13	62	62
	Low	9	11	7	12	58	57

Temporal Horn Current

Pattern	Volume	Max. RMS Operating Current (mA RMS Current)				dBA Reverberant Ratings per UL464 (dBA @ 10 ft.)	
		Reg 12 VDC	Reg 12 FWR	Reg 24 VDC	Reg 24 FWR	Reg 12 VDC/ FWR	Reg 24 VDC/ FWR
2400 Hz	High	124	70	87	132	82	82
	Mid	46	38	30	83	77	79
	Low	30	28	18	36	74	75
Electro-Mechanical	High	114	69	80	134	83	82
	Mid	42	40	27	67	78	80
	Low	28	27	16	36	75	76
Broadband	High	151	117	80	146	82	82
	Mid	45	59	26	73	77	78
	Low	30	42	16	31	75	76
Chime	High	29	35	21	28	68	70
	Mid	10	17	9	12	61	61
	Low	9	12	8	9	55	55

March Time Horn Current

Pattern	Volume	Max. RMS Current (mA RMS Current)				dBA Reverberant Ratings per UL464 (dBA @ 10 ft.)	
		Reg 12 VDC	Reg 12 FWR	Reg 24 VDC	Reg 24 FWR	Reg 12 VDC/ FWR	Reg 24 VDC/ FWR
2400 Hz	High	121	70	92	132	83	84
	Mid	47	39	31	76	79	81
	Low	36	25	19	35	76	77
Electro-Mechanical	High	114	69	86	125	83	83
	Mid	42	37	27	67	80	81
	Low	30	26	19	37	77	77
Broadband	High	153	121	77	126	83	84
	Mid	42	55	28	56	79	80
	Low	29	42	16	26	76	77

■ Wiring Diagram

Horn / Strobe Signal Operate Independently

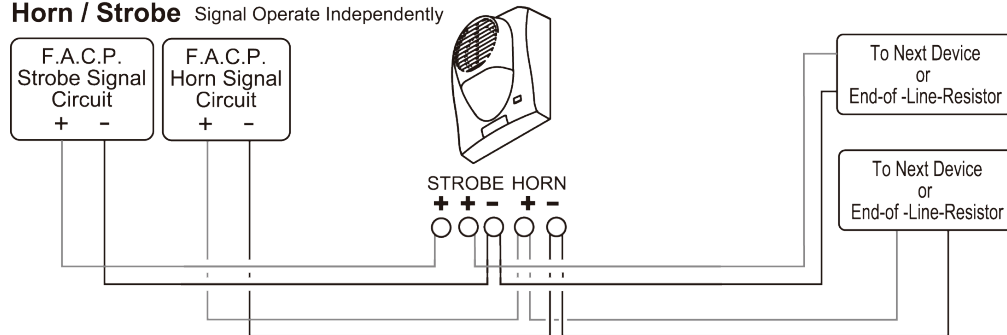

Horn / Strobe Wiring Diagram for Audible Strobe Class "B" Circuit with Audible Silence Feature.

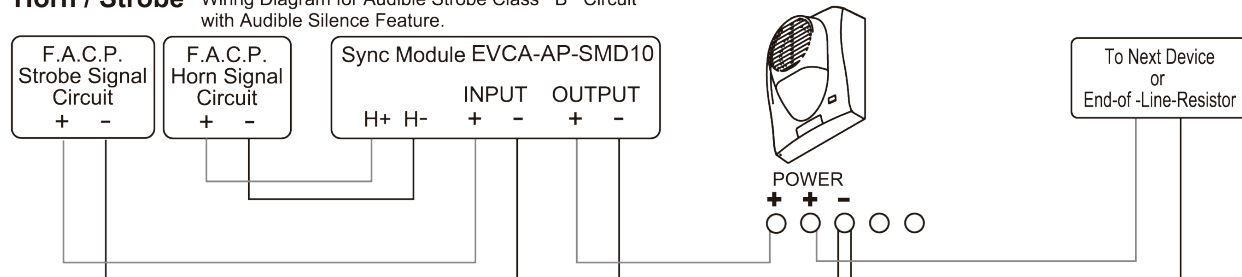

Horn or Strobe Wiring Diagram for Audible Strobe Class "B" Circuit without Audible Silence Feature.

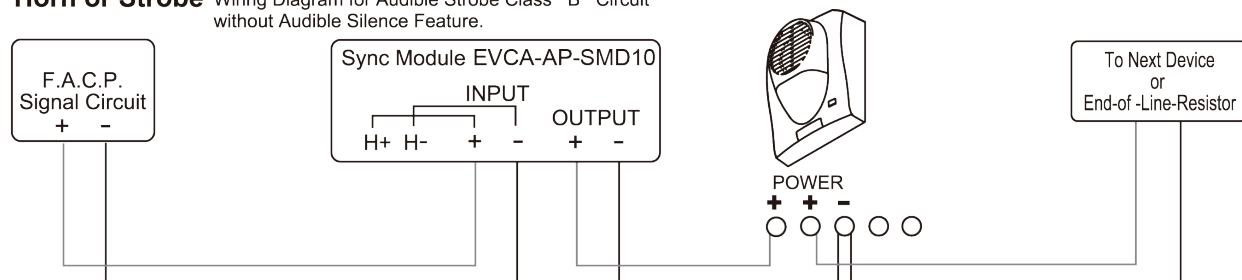

Refer to the EVCA-AP-SMD10 Sync Module instruction manual for Class "A" wiring or other application diagrams.

■ Ordering Information

Model Number	Description
EVCA-AP-SH	Wall Mount Horn/Strobe
EVCA-AP-BBX-5	Weatherproof Backbox
EVCA-AP-SMD10	Horn/Strobe Sync. Module

Distributed By

All specifications are subject to change without any notice.
For more information, contact with NITTAN.

NITTAN

Nittan Europe Ltd, Hipley Street
Old Woking, Surrey, GU22 9LQ UK
TEL: +44 1483 769555 FAX: +44 1483 756686