



# Evolution Wall or Ceiling Mount Sounder Beacon

## **EV-AV2**

Part no. F14-85012

### General Description

EV-AV2 Type A Indoor Wall or Ceiling Mountable Sounder Beacon VID for use as part of an Evolution analogue addressable system.

The Sounder Beacon can be soft addressed using the EV-AD2-EXT handheld programmer using the EV-AVADAPT adaptor plate, which is supplied in the Programming Kit.

The Sounder includes 12 Tones, which can be selected via the DIP Switch, three of which are Approved. Volume can also be set via the POT.

The Beacon includes High and Low Power settings, which can be selected via the DIP Switch (Default Low).

### Approvals

|                  |                          |
|------------------|--------------------------|
| Test Standards   | EN 54-3: 2001 + A2: 2006 |
| CPR Certificate  | 0786-CPR-21232           |
| UKCA Certificate | 0359-UKCA-CPR-00128      |
| DoP Number       | 21232                    |

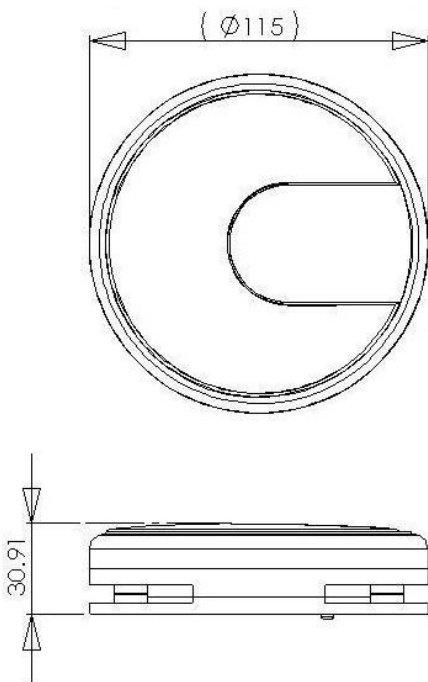

### Data

|                       |  |
|-----------------------|--|
| Sounder Device Type   | Piezo                                      |
| Sounder Output        | 73 to 88 dB(A) @ 90° / 1 metre.            |
| Sounder Tones         | 12 Tones DIP Switch select (3 Approved)    |
| Beacon Device         | 2 x High Power LED                         |
| Operating voltage     | 24 Vdc to 38 Vdc                           |
| Quiescent current     | 200 µA                                     |
| Alarm current         | 9.5 mA (Beacon Low)<br>14 mA (Beacon High) |
| Maximum Power         | 530 mW                                     |
| Ingress protection    | IP21C                                      |
| Operating temperature | -10°C to +55°C                             |
| Storage temperature   | -25°C to +70°C                             |
| Relative humidity     | RH 95%                                     |
| Cable terminals       | Max 2.5 mm <sup>2</sup>                    |
| Material              | ABS  |
| Dimensions            | Ø 115 mm x 30.91 mm                        |
| Weight                | 200 g                                      |

**All wiring must conform to the current edition of IEE Wiring regulations and BS5839 Part 1, or Local National Wiring regulations.**

**All loop Cable Screens shall be connected together, but must be Isolated from Ground. Cable Screens shall be connected to Earth Ground within the Control Panel ONLY.**

### Connections

